

SCHALTGERÄTE

Komplett-Typen Baureihe MN

Complete types Series MN

Hauptschalter/ Not-Aus-Schalter

Fronteinbau

Main switches Emergency-off switches

Front mounting

Zentralbefestigung 22,5 und 30,5 mm mit Vorhängeschlossperre für 1 oder 2 Vorhängeschlösser

mit Bügeldurchmesser bis 5 mm,
ML-Schalter mit Klemmenabdeckung

Griff/Frontschild
rot/gelb rt/ge (mit Not-Aus Funktion)
oder schwarz/silber sw/si

Central mounting 22.5 and 30.5 mm with lockout handle for 1 or 2 padlocks

with shackle diameter up to 5 mm,
ML-switches with terminal cover

handle/front plate
red/yellow rd/ye (with Emergency-off function)
or black/silver bk/si



Abmessungen / Dimensions
Bauform / Design: 0260-EV / 0260-EVS

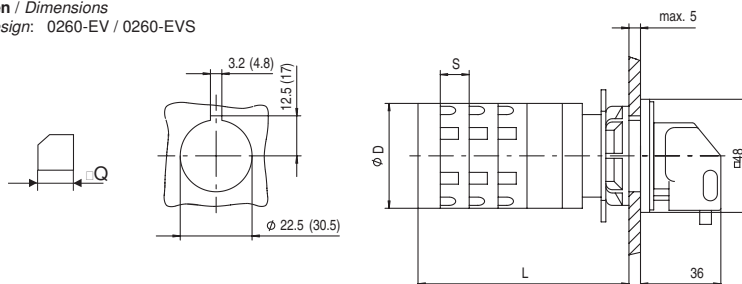

| Baureihe Series | Abmessungen (mm) Dimensions (mm) | | | | | L bei _Schaltkontakten L by _switch contacts | | | |
|--------------------|-------------------------------------|----|----|------|---|---|-------|------|------|
| | D | F | H | S | Q | 1/2 | 3/4 | 5/6 | 7/8 |
| 104 | 44 | 48 | 35 | 16 | 6 | 57 | 73 | 89 | 105 |
| 105 | 44 | 48 | 35 | 12.5 | 6 | 48 | 60.5 | 73 | 85.5 |
| 111 | 52 | 64 | 35 | 12 | 6 | 60 | 60/72 | 72 | 84 |
| 151 | 49 | 48 | 35 | 12.5 | 6 | 68.5 | 81 | 93.5 | 106 |

Schaltprogramm
Contact arrangement

Dauerstrom I_{th}
Rated
Uninterrupted
current I_{th}
A

Leistung
Rating
AC 3
kW

Leistung
Rating
AC 23A
kW

Baureihe
Series

Griff-/
Frontschild
handle/
front plate

Typ
Type

Best.Nr.
Part #

| | | | | | | | |
|-------------------|----|-----|-----|-----|-------------|-------------------|------------------|
| 1-polig 1-pole | 20 | 5,5 | 7,5 | 104 | rt/ge rd/ye | A 104/62.0260-EV | MZ 10 061 |
| | 20 | 5,5 | 7,5 | 104 | sw/si bk/si | A 104/62.0260-EVS | MZ 10 062 |
| | 25 | 5,5 | 7,5 | 105 | rt/ge rd/ye | A 105/62.0260-EV | MZ 12 061 |
| | 25 | 5,5 | 7,5 | 105 | sw/si bk/si | A 105/62.0260-EVS | MZ 12 062 |
| | 32 | 7,5 | 11 | 151 | rt/ge rd/ye | A 151/62.0260-EV | MZ 17 061 |
| | 32 | 7,5 | 11 | 151 | sw/si bk/si | A 151/62.0260-EVS | MZ 17 062 |

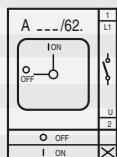

| Schaltprogramm Contact arrangement | Dauerstrom I_{th} Rated Uninterrupted current I_{th} A | Leistung Rating AC 3 kW | Leistung Rating AC 23A kW | Baureihe Series | Griff-/ Frontschild handle/ front plate | Typ Type | Best.Nr. Part # |
|---|--|----------------------------------|------------------------------------|--------------------|--|-------------------|--------------------|
| 2-polig 2-pole | 20 | 5,5 | 7,5 | 104 | rt/ge rd/ye | A 104/50.0260-EV | MZ 10 063 |
| | 20 | 5,5 | 7,5 | 104 | sw/si bk/si | A 104/50.0260-EVS | MZ 10 064 |
| | 25 | 5,5 | 7,5 | 105 | rt/ge rd/ye | A 105/50.0260-EV | MZ 12 063 |
| | 25 | 5,5 | 7,5 | 105 | sw/si bk/si | A 105/50.0260-EVS | MZ 12 064 |
| | 32 | 7,5 | 11 | 151 | rt/ge rd/ye | A 151/50.0260-EV | MZ 17 063 |
| | 32 | 7,5 | 11 | 151 | sw/si bk/si | A 151/50.0260-EVS | MZ 17 064 |
| 3-polig 3-pole | 20 | 5,5 | 7,5 | 104 | rt/ge rd/ye | A 104/6.0260-EV | MZ 10 065 |
| | 20 | 5,5 | 7,5 | 104 | sw/si bk/si | A 104/6.0260-EVS | MZ 10 066 |
| | 25 | 5,5 | 7,5 | 105 | rt/ge rd/ye | A 105/6.0260-EV | MZ 12 065 |
| | 25 | 5,5 | 7,5 | 105 | sw/si bk/si | A 105/6.0260-EVS | MZ 12 066 |
| | 32 | 7,5 | 11 | 151 | rt/ge rd/ye | A 151/6.0260-EV | MZ 17 065 |
| | 32 | 7,5 | 11 | 151 | sw/si bk/si | A 151/6.0260-EVS | MZ 17 066 |
| 4-polig 1 Kontakt voreilend 4-pole 1 contact priority | 20 | 5,5 | 7,5 | 104 | rt/ge rd/ye | A 104/22.0260-EV | MZ 10 067 |
| | 20 | 5,5 | 7,5 | 104 | sw/si bk/si | A 104/22.0260-EVS | MZ 10 068 |
| | 25 | 5,5 | 7,5 | 105 | rt/ge rd/ye | A 105/22.0260-EV | MZ 12 067 |
| | 25 | 5,5 | 7,5 | 105 | sw/si bk/si | A 105/22.0260-EVS | MZ 12 068 |
| | 32 | 7,5 | 11 | 151 | rt/ge rd/ye | A 151/22.0260-EV | MZ 17 067 |
| | 32 | 7,5 | 11 | 151 | sw/si bk/si | A 151/22.0260-EVS | MZ 17 068 |
| 6-polig 6-pole | 20 | 5,5 | 7,5 | 104 | rt/ge rd/ye | A 104/10.0260-EV | MZ 10 071 |
| | 20 | 5,5 | 7,5 | 104 | sw/si bk/si | A 104/10.0260-EVS | MZ 10 072 |
| | 25 | 5,5 | 7,5 | 105 | rt/ge rd/ye | A 105/10.0260-EV | MZ 12 071 |
| | 25 | 5,5 | 7,5 | 105 | sw/si bk/si | A 105/10.0260-EVS | MZ 12 072 |
| | 32 | 7,5 | 11 | 151 | rt/ge rd/ye | A 151/10.0260-EV | MZ 17 071 |
| | 32 | 7,5 | 11 | 151 | sw/si bk/si | A 151/10.0260-EVS | MZ 17 072 |